

**SKETCH MAP SHOWING THE LAND OVER
R.S. PLOT NO:- 1402(P), & 3064(P), L.R PLOT NO:- 2284, & 2285,
L.R KHATIAN NO:- 6453, J.L. NO-119, OF MOUZA - BHIRINGI,
P.S.- DURGAPUR, DIST - PASCHIM BARDHAMAN.**

LAND OWNER
AREA OF LAND

NIRMAL KUMAR MONDAL, S/O LATE JATADHARI MONDAL

PLOT NO.
1402(P), & 3064(P) (R.S)
2284 & 2285 (L.R)

SHOW AREA
16 DECIMAL

N

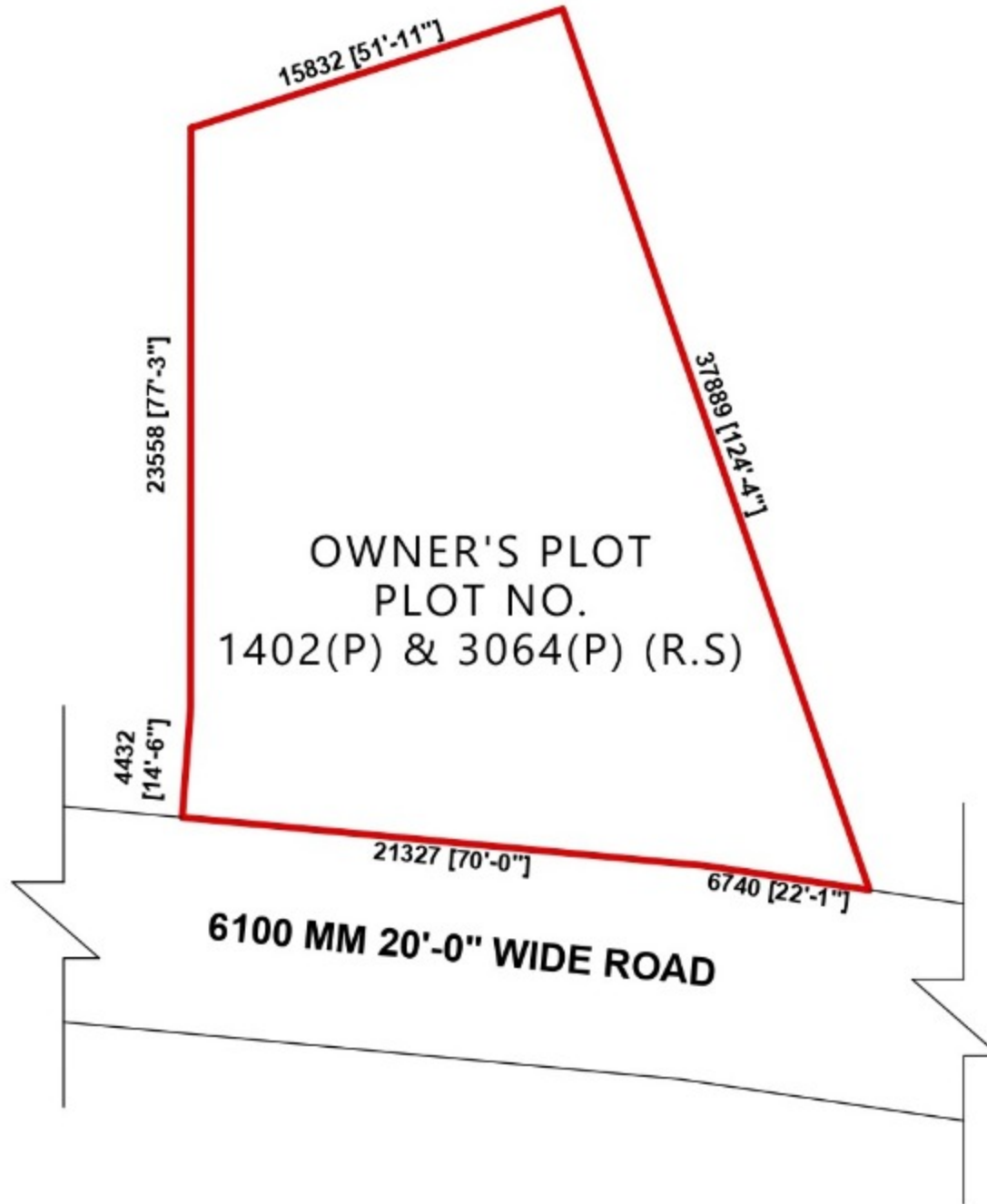

LAT:23.562140 , LONG:- 87.27418440

**R.S. PLOT NO:- 1402(P), & 3064(P),
J.L NO:- 119, MOUZA:-BHIRINGI
SCALE 16 INCH=1 MILE PLOT-RED MARKED**

L.B.S STAMP SIGNATURE

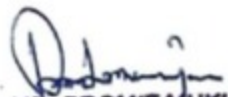
MR. PROMIT MUKHERJEE
(LICENSED BUILDING SURVEYOR)
DURGAPUR MUNICIPAL CORPORATION
Add. : A/2, Ispatpally, Bidhannagar, Dgp-12
Ph. : 9547417018
Lic. No. : DMC/BPD/LBSII/202

